

Getting Started

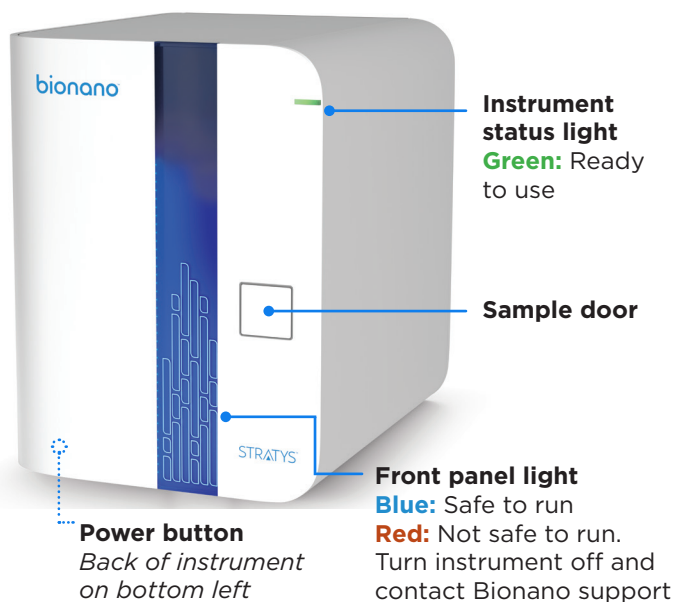

CAUTIONS AND REMINDERS

CAUTIONS

- Do not open Stratys Chip when cold.**
 - Equilibrate the chip to room temperature for 30 minutes.
 - Load samples immediately after equilibration.
- Improper chip handling can lead to damage and breakage.**
 - Handle the chip by the sides using powder-free gloves. Do not touch the bottom.
 - Do not apply excessive pressure when loading the wells.
 - Place chip onto lint-free paper and a level lab bench before closing the lid.

REMINDERS

- Use acceptable pipette tips to load chips (See Table 1).**
- Fully immerse pipette tip in sample before aspirating to avoid air gaps and bubbles during chip loading.**
- Before loading chip into the instrument, use lens paper to wipe away any dust and debris on the bottom.**

Before Starting

- Equilibrate samples and Stratys Chip to room temperature for at least 30 minutes.
- Using Stratys DLS-G2 Protocol, ensure a minimum of 20µl of labeled DNA at 4-16ng/µl per sample.
- Use only acceptable pipette tips (See Table 1).
- Read the Quick Tips on the back of this page.

Table 1. Acceptable Pipette Tips

Brand	Description	Part #	Performance
Olympus	Barrier, Racked, Low Retention, Sterile	26-400	Preferred
Microlit	ProTip, Low Retention Filter, Racked, Sterile	R-10-FS	Preferred
ART10	Barrier, Low Retention	2139	Preferred
USA Scientific	TipOne RPT Filter, Ultra-low Retention	1181-3810	Preferred
Corning	DeckWorks Barrier, Low-binding, Sterile	CLS4135	Acceptable
Greiner	Sapphire, Sterile	771352	Acceptable
VWR	Universal Filter, Low Retention	732-3631	Acceptable

Quick Tips (see back)

Preparing Chip — Loading Instrument — Performing Run



Preparing Chip

Load the Wells as shown (see Table 2)

- Keep the pipette perpendicular to the chip
- Ensure tip makes contact with the bottom
- Dispense samples slowly (25 sec), then hold plunger at first stop 5 sec before removing



Table 2. Loading Volumes

Well	Sample	Nuclease-Free water
Inlet	8µl	2µl
Outlet	10µl	2µl

Close the Lid of the Chip as shown

On a stable surface, press down on the tip of the lid where indicated.

Do NOT press lid at the center.



Loading Instrument

Load and Prioritize Chips as shown

On **Home** screen, choose to load regular or priority chips.

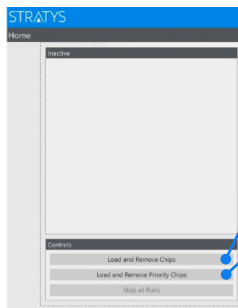

Run a **normal batch** workflow.

Run a **priority batch** workflow. Prioritized chips (3 max) will be processed first during data acquisition and analysis.

Chip Cleaning Tips

Before loading the chip into the Stratys, check the bottom of the chip for cracks, dust, or debris. If there is any dust or debris, gently wipe the underside of the chip with lens paper.

Place the chip in the instrument as shown



Performing Run

Configure Run as shown

User can configure runs for inserted chips while additional chips are being inserted.

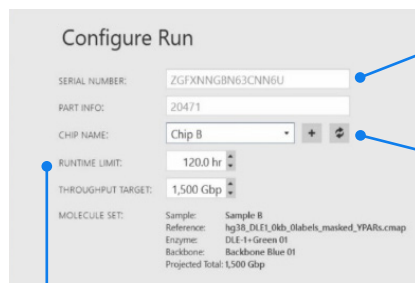

Newly inserted chip serial number is shown.

Select the Chip Name that was previously set up in Bionano Access.

Review Runtime and Throughput Target parameters and modify as desired.

Monitoring Runs

During scanning, the user can view the Run metrics on the **Home** screen or in Bionano Access.

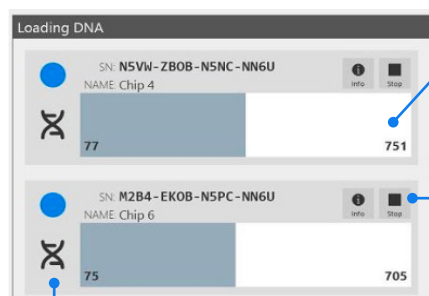

Status bar shows progress towards completing data collection.

Run can be stopped before it reaches set limits.

Hover over icon for information on chip status.



Questions? Check out our Stratys user guide and training videos for more information.